

3

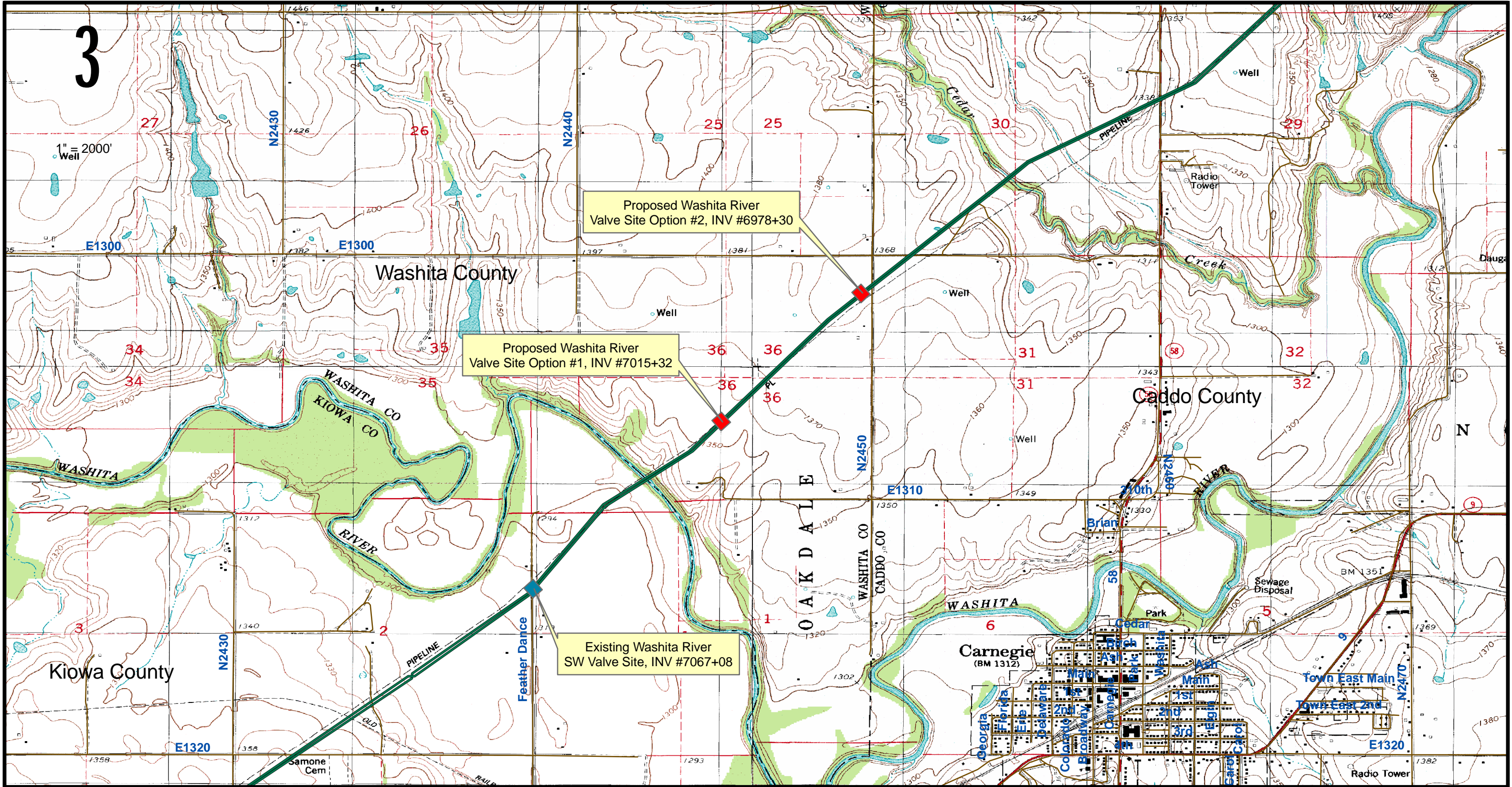

NOTES:

DRAWING NO.		REFERENCE TITLE				
NO.	DATE	BY	REVISION DESCRIPTION	W.O. NO.	CHK.	APP.

CENTURION DUAL 16" PIPELINE SYSTEM  
VICINITY MAP  
PROPOSED VALVE SITE #1, INV #701532  
PROPOSED VALVE SITE #2, INV #6978+30  
WASHITA COUNTY, OKLAHOMA

**MEI MAVERICK ENGINEERING, INC.**  
www.maverickengineering.com

SCALE: 1=2000'

ISSUED FOR BID: \_\_\_\_\_  
ISSUED FOR CONSTRUCTION: \_\_\_\_\_

NUMBER: B-07473802-0735-5000

SHEET 1 OF 1

DRAWN BY: MEI	DATE: 02-01-08	ISSUED FOR BID: _____
CHECKED BY: _____	DATE: _____	ISSUED FOR CONSTRUCTION: _____
APPROVED BY: _____	DATE: _____	NUMBER: B-07473802-0735-5000
REV: _____		